

IVS: OFFICE LAYOUT\_2ND FLOOR  
Scale 1:100

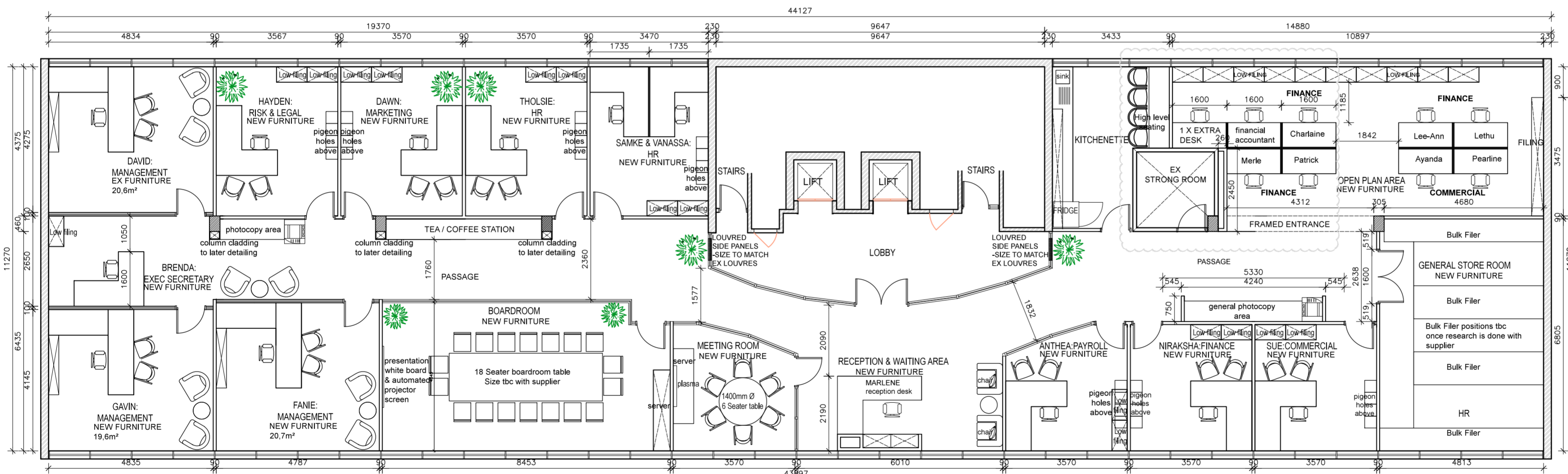

IVS: OFFICE LAYOUT\_3RD FLOOR  
Scale 1:100

**CHARTER HOUSE: IVS**  
**REV 02 (11/09)**

**LEVEL 2:**

- ENTRANCE DOOR MOVED TO EXISTING SITE POSITION
- ADDITIONAL DRYWALL ADDED IN OPEN PLAN OFFICE
- ADDITIONAL FILING AREA CREATED

**LEVEL 3:**

- FURNITURE RE-ARRANGED AS REQUESTED BY CLIENT

**REV 03(18/09)**

- ANTHEA'S DESK REVISED
- ENTRANCE DOOR SWING REVISED

**CHARTER HOUSE: IVS**  
**REV 04(07/10)**

**LEVEL 3:**

- DRYWALL POSITION BETWEEN KITCHEN & OPEN PLAN UPDATED
- ADDITIONAL DRYWALL ADDED IN OPEN PLAN OFFICE
- ADDITIONAL DESK ADDED

**notes:**

- FIGURED DIMENSIONS TO BE USED IN PREFERENCE TO SCALING
- CHECK ALL DIMENSIONS AND LEVELS ON SITE PRIOR TO THE COMMENCEMENT OF WORK AND IMMEDIATELY REPORT ANY DISCREPANCIES TO THE DESIGNER.
- ALL BUILDING WORK AND REGULATIONS ARE TO BE CARRIED OUT IN STRICT ACCORDANCE WITH THE NATIONAL BUILDING REGULATIONS (SABS 0400-1990), THE OCCUPATIONAL HEALTH & SAFETY ACT (1993) AND THE CONSTRUCTION REGULATIONS ACT OF 2003.
- ALL CONCRETE AND STRUCTURAL STEEL WORK IS TO BE IN ACCORDANCE WITH THE STRUCTURAL ENGINEER'S DESIGN AND SPECIFICATION.
- DRAINAGE - ALL PLUMBING AND DRAINAGE WORK AND INSTALLATION OF SANITARYWARE TO COMPLY WITH SABS 0400-1990 PART F.
- GLAZING NOTES - SPECIFICATIONS TO COMPLY WITH SABS 0400-1990 PART N.
- STAIR NOTES SPECIFICATIONS TO COMPLY WITH SABS 0400-1990 PART M.
  - RISERS TO NOT EXCEED 200mm IN HEIGHT
  - TREADS TO NOT BE LESS THAN 250mm IN DEPTH
  - NO OPENING TO BE GREATER THAN 100mm
  - MIN HEIGHT OF BALUSTRADE TO BE 1050mm

**revision:**

01	REFER TO DWG	27/08
02	REFER TO DWG	11/09
03	REFER TO DWG	16/09
04	REFER TO DWG	07/10

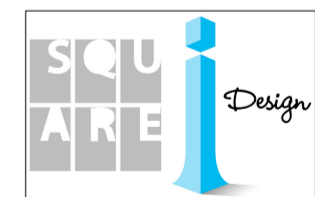

cell: 084 513 7586 / 0794977409  
email: squaredesign1@gmail.com  
26 ashwin ave, westville, 3630

[www.squareidesign.co.za](http://www.squareidesign.co.za)

client:

LA BAMBA  
IVS

project:

NEW OFFICE  
CHARTER HOUSE

drawing title:

LEVEL 2(HALF) & LEVEL 3  
FLOOR PLAN LAYOUT

scale: 1:100

date: 14.08.2013

drawing no: SID 018/01

revision: 04