

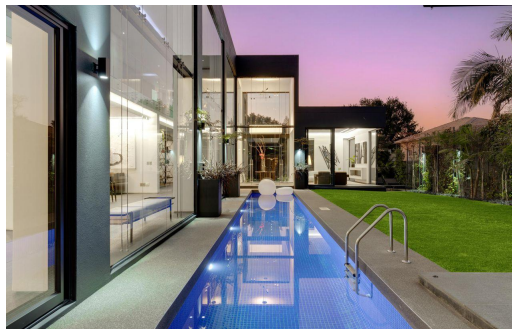

4

4

3



R21,000,000

House For Sale in Hyde Park



| | | | |
|---------------------|---------------------|------------------------|-----|
| FLOOR SIZE | 900m ² | GARAGES | 3 |
| LAND SIZE | 1,132m ² | PARKINGS | - |
| BEDROOMS | 4 | FLATLETS | - |
| BATHROOMS | 4 | DOMESTIC ACCOM. | 1 |
| KITCHENS | 1 | POOL | Yes |
| LOUNGES | 2 | PETS ALLOWED | Yes |
| DINING ROOMS | 1 | | |
| STUDIES | 1 | | |

RATES R10,600 pm (Estimated)
LEVY R2,500 pm



Stephen Brick
082 551 7971
stephen@vered.co.za